

Size 1* Square Body Fuse Links 2000Vdc, 10A to 100A, 170E Series

Description: A range of square body high speed traction fuse link which provides superior protection in DC traction applications up to 2000Vdc

Technical Data:

Rated Voltage: 2000Vdc
 Rated Current: 10-100A
 Tested Breaking Capacity:
 40kA at 2000Vdc, L/R 30ms

Class of Operation: aR

Fuse Link Size: 1*

Standards/Approvals: Consult Cooper Bussmann.



Typical Applications

- Auxiliary converters
- Lights
- Power distribution converter

Catalogue Numbers

Catalogue Number	Fuse Link Type	Fuse Link Size	Operating Class	Rated Voltage (Vdc)	Rated Current (Amps)	Watts Loss (W)
170E3977	Knife Blade Style	1*	aR	2000	10	7
170E3982					12	8
170E3971					16	11
170E3906					20	13
170E3907					25	17
170E3908					32	22
170E3909					40	27
170E3910					50	34
170E3911					63	43
170E3912					80	50
170E3946					100	61

Dimensions - mm

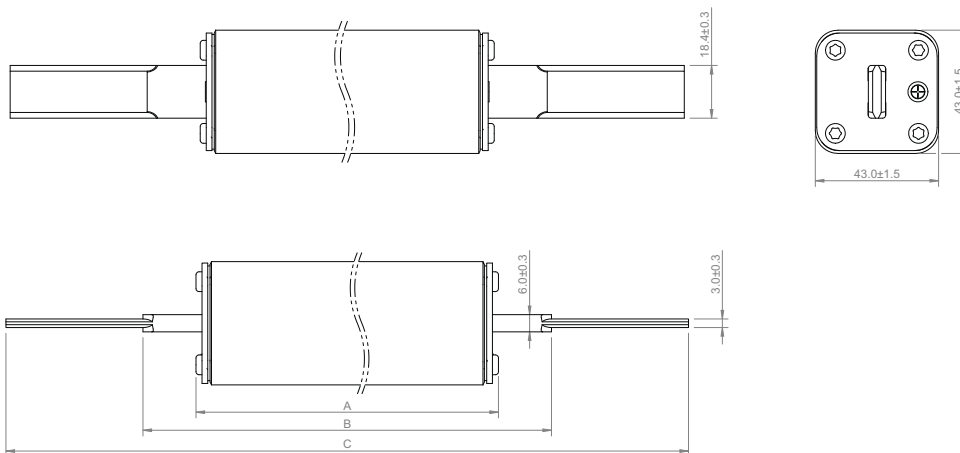

A	B	C
215 ± 2.5	250.5 ± 3.2	345.5 ± 3.5

Data Sheet: 170K4900