

## Size 1\* Square Body Fuse Links 1200Vdc, 20A to 215A, 170M Series

**Description:** A range of square body high speed traction fuse links for superior protection of DC third rail applications up to 1200Vdc.

**Technical Data:**

Rated Voltage: 1200Vdc  
 Rated Current: 20-215A  
 Tested Breaking Capacity:  
 50kA at 1350Vdc, L/R 12ms

**Class of Operation:** aR

**Fuse Link Size:** 1\*



**Standards/Approvals:** IEC 60269

**Microswitch (optional):** 170H0069, Type K indicator 6.3 x 0.8mm lugs, low operating voltage.

**Features and Product Benefits**

- Low watts loss
- High breaking capacity
- Low arc voltage

**Typical Applications**

- Protection of High Speed Circuit Breaker
- Heating Ventilation Air Conditioning (CHVAC)
- Third Rail converter

**Catalogue Numbers**

Catalogue Number	Fuse Link Type	Fuse Link Size	Rated Voltage (Vdc)	Rated Current (Amps)	Energy Integrals I <sup>2</sup> t (A <sup>2</sup> s)		Watts Loss (W)	
					Pre-Arcing	Total at 1200Vdc	0.8 I <sub>n</sub>	I <sub>n</sub>
170M2100	Single Slot Tag	1*	1200	20	82	249	1	2
170M2101				25	173	526	4	8
170M2102				32	327	994	5	9
170M2103				40	550	1675	1	9
170M2104				50	950	2890	7	13
170M2105				63	1310	3990	5	9
170M2106				80	1970	6000	13	23
170M2107				100	3800	11,600	14	26
170M2108				125	8550	26,025	13	24
170M2109				160	8770	26,700	24	44
170M2110				200	15,200	46,300	29	52
170M2111				215	16,430	50,000	32	58

**Dimensions - mm**

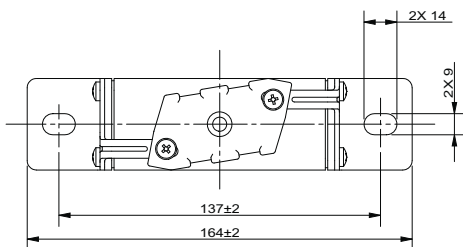
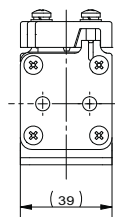
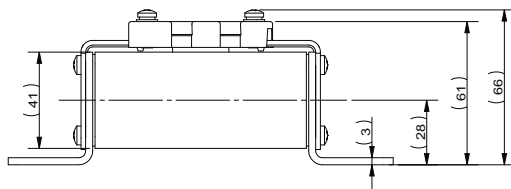

**Data Sheet:** 720141