

Low Voltage Current Limiting Fuse

LVCLF

저압 한류형 퓨즈

Low Voltage Current Limiting Fuse



■ 제품소개 / 특징(Introduce/Features)



고성능, 대차단용량을 자랑하는 반도체 보호전용 고속도 한류퓨즈

본 퓨즈의 가용체는 종래 제작방식을 탈피하여 혁신적인 특허 제조방법으로 양산되며, 용단특성·차단특성 및 기계적강도 등 대폭 개량된 신제품입니다. 더욱이 본 제품은 UL248 규격에 의거 UL 인증시험을 필한 제품입니다.

- 대차단용량과 뛰어난 한류차단
- 아주 적은 동작 IT와 낮은 동작과전압으로 반도체보호에 최적
- 특성이 균일하고 경년변화가 없다.
- 소형경량으로 장치가 작아진다.
- 직류전류도 차단가능
- UL인증 : E148347
- 특허 출원건
 - 네트워크 퓨즈엘리먼트(제073029)
 - Fuse(제127926호)
 - ISG방법에 의한 금속과 세라믹 기판과의 합성코팅방법(제173404호)

구조(Structure)

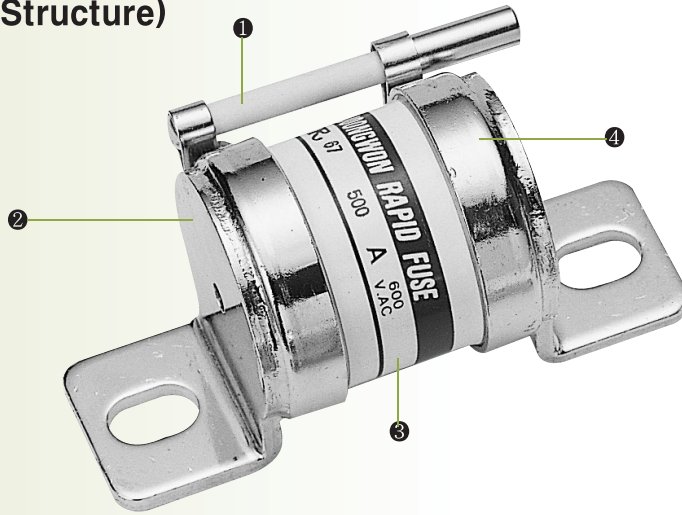

- ① Indicator
- ② Terminal
- ③ Ceramic Tube
- ④ Cap

정격 / 외형치수(Ratings / Outline Dimensions)

▶ 300V

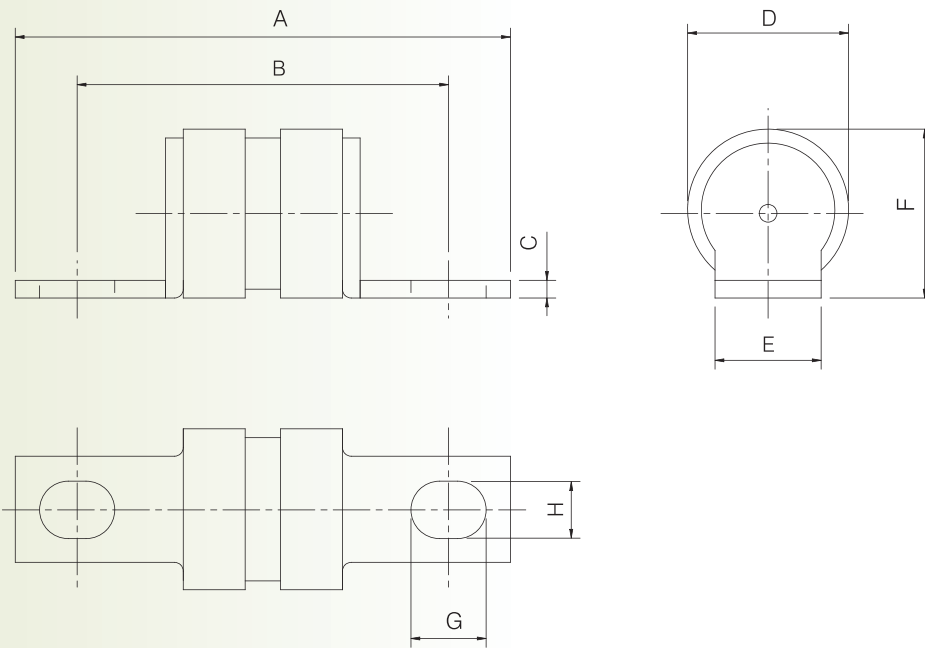

형식 Type	정격전압 Rated voltage	정격전류(A) Rated current	차단용량(kA) Breaking capacity	치수(mm) Dimension							
				A	B	C	D	E	F	G	H
JR31	300V (AC/DC)	20 · 30 · 40 · 50 · 60	100	56	42	2	18.2	12	19.1	8.5	6.5
JR32		60 · 80 · 100 · 120		58	42	2.5	21.3	15	21.7	11	9
JR33		90 · 120 · 150 · 180		80	58	3	26.8	20	27.4	11	9
JR36		150 · 200 · 250 · 300		85	60	3	35.6	25	38.8	16	10.3
JR37		350 · 400 · 450 · 500		90	65	3.5	47.5	32.4	51.5	16	10.3

정격 / 외형치수(Ratings / Outline Dimensions)

▶ 600V

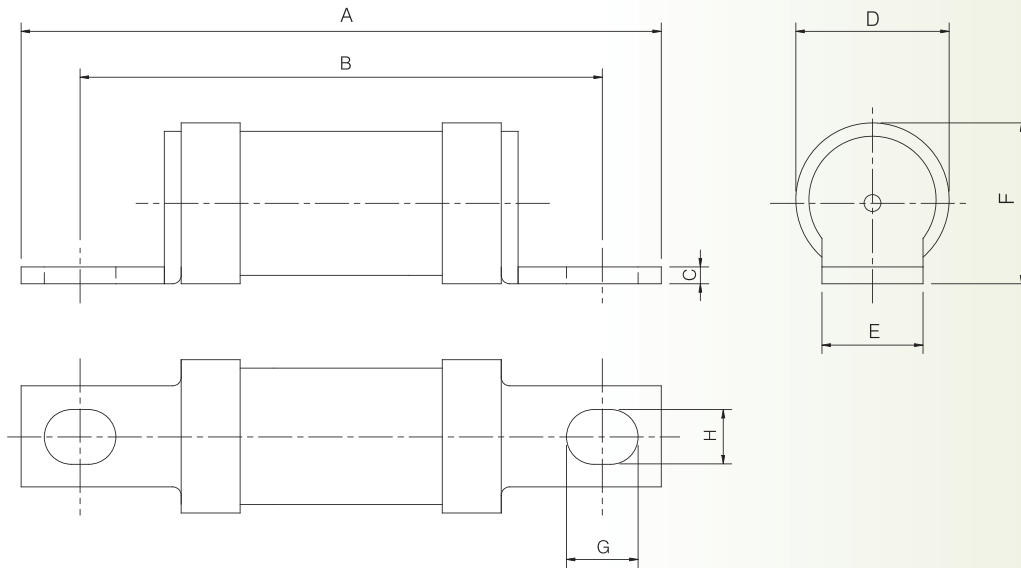

형식 Type	정격전압 Rated Voltage	정격전류(A) Rated current	차단용량(kA) Breaking capacity	외형치수(mm) Dimension							
				A	B	C	D	E	F	G	H
JR61	600V (AC/DC)	20 · 30 · 40 · 50 · 60	100	76	62	2	18.2	12	19.1	8.5	6.5
JR62		60 · 80 · 100 · 120		90	70	2.5	21.3	15	21.7	11	9
JR63		90 · 120 · 150 · 180		90	70	3	26.8	20	27.4	11	9
JR66		150 · 200 · 250 · 300		106	81	3	35.6	25	38.8	16	10.3
JR67		350 · 400 · 450 · 500		107	85	3.5	47.5	32.4	51.5	16	10.3

▶ 표시기
(Indicator Type)

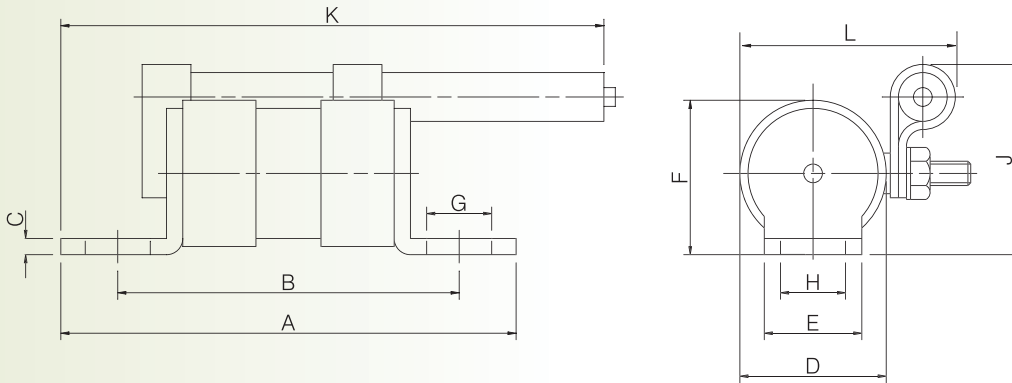

형식 Type	치수(mm) / Dimension										
	A	B	C	D	E	F	G	H	J	K	L
JR31	56	42	2	18.2	12	19.1	8.5	6.5	23.8	56.8	27
JR32	58	42	2.5	21.3	15	21.7	11	9	24.8	57.8	30.1
JR33	80	58	3	26.8	20	27.4	11	9	27.8	68.3	35.6
JR36	85	60	3	35.6	25	38.8	16	10.3	34.8	70.2	44.4
JR37	90	65	3.5	47.5	32.4	51.5	16	10.3	42	71.2	55.1
JR61	76	62	2	18.2	12	19.1	8.5	6.5	23.8	75.8	27
JR62	90	70	2.5	21.3	15	21.7	11	9	24.8	81.8	30.1
JR63	90	70	3	26.8	20	27.4	11	9	27.8	81.8	35.6
JR66	106	81	3	35.6	25	38.8	16	10.3	34.8	90.1	44.4
JR67	107	85	3.5	47.5	32.4	51.5	16	10.3	42	91.1	55.1

정격 / 외형치수(Ratings / Outline Dimensions)

표시기 & Micro switch형(Indicator & Micro Switch Type)

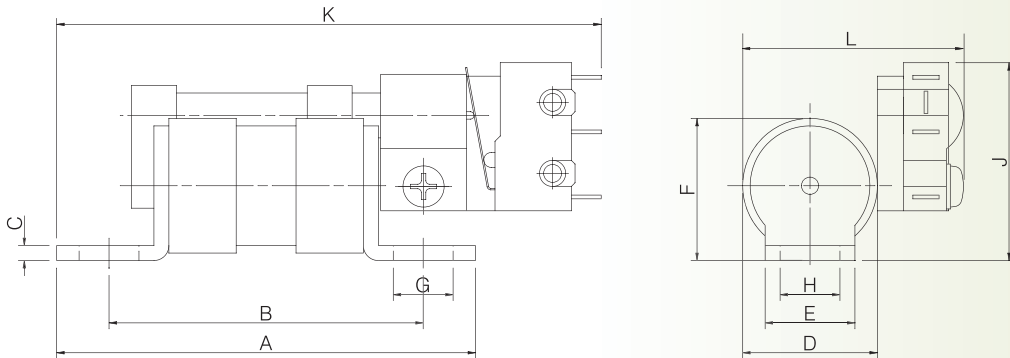

형식 Type	치수(mm) / Dimension										
	A	B	C	D	E	F	G	H	J	K	L
JR31	56	42	2	18.2	12	19.1	8.5	6.5	27	75	28.7
JR32	58	42	2.5	21.3	15	21.7	11	9	28	76	31.9
JR33	80	58	3	26.8	20	27.4	11	9	31	86.5	37.3
JR36	85	60	3	35.6	25	38.8	16	10.3	38	88.4	46.1
JR37	90	65	3.5	47.5	32.4	51.5	16	10.3	45.2	89.4	56.8
JR61	76	62	2	18.2	12	19.1	8.5	6.5	27	94	28.7
JR62	90	70	2.5	21.3	15	21.7	11	9	28	100	31.9
JR63	90	70	3	26.8	20	27.4	11	9	31	100	37.3
JR66	106	81	3	35.6	25	38.8	16	10.3	38	108.3	46.1
JR67	107	85	3.5	47.5	32.4	51.5	16	10.3	45.2	109.3	56.8



■ 성능 / 주문방식 (Performance / Order Sheet)

▶ JR30 Type

형 식(Type)			JR 30			
일반형 General	표시기부착 Ind. type	M/SW 부착 M/SW type	정격전류(A) Rated current	용단(I ² T) Pre-arcing	동작(I ² T) Operating	전력손실(W) Electric power loss
JR31-10	JR31-10I	JR31-10IS	10	1	7	3
JR31-15	JR31-15I	JR31-15IS	15	6	28	3.2
JR31-20	JR31-20I	JR31-20IS	20	10	45	3.5
JR31-25	JR31-25I	JR31-25IS	25	16	80	4.8
JR31-30	JR31-30I	JR31-30IS	30	20	110	6.7
JR31-32	JR31-32I	JR31-32IS	32	23	130	7.0
JR31-35	JR31-35I	JR31-35IS	35	40	170	7.2
JR31-40	JR31-40I	JR31-40IS	40	50	220	7.5
JR31-50	JR31-50I	JR31-50IS	50	85	450	8
JR31-60	JR31-60I	JR31-60IS	60	150	800	9.0
JR31-63	JR31-63I	JR31-63IS	63	170	1,100	9.2
JR31-75	JR32-75I	JR31-75IS	75	230	1,650	10
JR31-80	JR32-80I	JR31-80IS	80	320	3,100	11
JR31-100	JR32-100I	JR31-100IS	100	450	5,500	14
JR32-60	JR32-60I	JR32-60IS	60	130	850	11
JR32-75	JR32-75I	JR32-75IS	75	220	920	11.2
JR32-80	JR32-80I	JR32-80IS	80	250	950	11.5
JR32-100	JR32-100I	JR32-100IS	100	500	2,100	14
JR32-120	JR32-120I	JR32-120IS	120	680	3,200	16.5
JR32-125	JR32-125I	JR32-125IS	125	720	4,500	17
JR32-160	JR32-160I	JR32-160IS	160	1,900	7,500	21
JR32-175	JR32-175I	JR32-175IS	175	2,200	10,500	24
JR33-40	JR33-40I	JR33-40IS	40	40	200	7.5
JR33-50	JR33-50I	JR33-50IS	50	70	370	8.4
JR33-60	JR33-60I	JR33-60IS	60	120	750	9.5
JR33-75	JR33-75I	JR33-75IS	75	250	1,020	10.5
JR33-85	JR33-85I	JR33-85IS	85	400	1,630	11.2
JR33-90	JR33-90I	JR33-90IS	90	500	1,890	12
JR33-100	JR33-100I	JR33-100IS	100	580	2,310	13.5
JR33-110	JR33-110I	JR33-110IS	110	630	2,860	14.2
JR33-120	JR33-120I	JR33-120IS	120	700	3,300	15.5
JR33-125	JR33-125I	JR33-125IS	125	750	3,400	16
JR33-140	JR33-140I	JR33-140IS	140	1,000	4,000	18
JR33-150	JR33-150I	JR33-150IS	150	1,400	4,400	19
JR33-160	JR33-160I	JR33-160IS	160	1,800	5,860	20.6
JR33-180	JR33-180I	JR33-180IS	180	2,000	7,680	22
JR36-150	JR36-150I	JR36-150IS	150	1,200	4,000	20
JR36-160	JR36-160I	JR36-160IS	160	1,700	4,900	21
JR36-180	JR36-180I	JR36-180IS	180	2,100	6,850	22
JR36-200	JR36-200I	JR36-200IS	200	2,500	7,800	24
JR36-215	JR36-215I	JR36-215IS	215	2,800	10,500	25.6
JR36-230	JR36-230I	JR36-230IS	230	3,600	12,500	27.2
JR36-250	JR36-250I	JR36-250IS	250	4,500	16,000	29
JR36-260	JR36-260I	JR36-260IS	260	4,800	20,100	30.5
JR36-300	JR36-300I	JR36-300IS	300	7,000	34,000	35
JR36-325	JR36-325I	JR36-325IS	325	9,000	40,000	36
JR37-350	JR37-350I	JR37-350IS	350	9,000	50,000	36
JR37-400	JR37-400I	JR37-400IS	400	14,000	73,000	40
JR37-450	JR37-450I	JR37-450IS	450	20,000	110,000	46
JR37-500	JR37-500I	JR37-500IS	500	32,000	160,000	50

- 정격전압(Rated voltage) : 300V AC/DC - 차단용량(Breaking capacity) : 100kA at 300V AC/DC - 동작과전압(Switching voltage) : 650V 이하(Less than 650V)

■ 성능 / 주문방식 (Performance / Order Sheet)

▶ JR60 Type

형 식(Type)			JR60			
일반형 General	표시기부착 Ind. type	M/SW 부착 M/SW type	정격전류(A) Rated current	용단(I ² T) Pre-arcing	동작(I ² T) Operating	전력손실(W) Electric power loss
JR61-10	JR61-10I	JR61-10IS	10	4	36	3.2
JR61-15	JR61-15I	JR61-15IS	15	7	50	4
JR61-16	JR61-16I	JR61-16IS	16	8	58	4.2
JR61-20	JR61-20I	JR61-20IS	20	12	100	6.5
JR61-25	JR61-25I	JR61-25IS	25	21	180	7.6
JR61-30	JR61-30I	JR61-30IS	30	34	250	9
JR61-32	JR61-32I	JR61-32IS	32	42	310	9.5
JR61-35	JR61-35I	JR61-35IS	35	59	400	10.2
JR61-40	JR61-40I	JR61-40IS	40	72	500	11
JR61-45	JR61-45I	JR61-45IS	45	98	780	12.4
JR61-50	JR61-50I	JR61-50IS	50	125	1,000	13.5
JR61-55	JR61-55I	JR61-55IS	55	180	1,400	14.3
JR61-60	JR61-60I	JR61-60IS	60	200	1,600	15.5
JR61-63	JR61-63I	JR61-63IS	63	250	1,760	16.7
JR61-75	JR61-75I	JR61-75IS	75	485	2,700	18.6
JR61-80	JR61-80I	JR61-80IS	80	580	3,100	19.7
JR62-60	JR62-60I	JR62-60IS	60	150	800	17
JR62-75	JR62-75I	JR62-75IS	75	410	2,350	18.2
JR62-80	JR62-80I	JR62-80IS	80	440	2,650	19
JR62-90	JR62-90I	JR62-90IS	90	590	4,300	20
JR62-100	JR62-100I	JR62-100IS	100	760	5,600	21
JR62-110	JR62-110I	JR62-110IS	110	980	7,700	21.5
JR62-120	JR62-120I	JR62-120IS	120	1,200	8,500	22
JR62-125	JR62-125I	JR62-125IS	125	1,300	9,300	22.5
JR63-90	JR63-90I	JR63-90IS	90	580	3,400	21
JR63-100	JR63-100I	JR63-100IS	100	720	4,400	22
JR63-110	JR63-110I	JR63-110IS	110	860	5,600	24
JR63-120	JR63-120I	JR63-120IS	120	920	6,300	25.5
JR63-140	JR63-140I	JR63-140IS	140	1,750	10,200	27.1
JR63-150	JR63-150I	JR63-150IS	150	2,100	12,000	29
JR63-160	JR63-160I	JR63-160IS	160	2,700	15,000	30.5
JR66-150	JR66-150I	JR66-150IS	150	1,600	9,200	30.5
JR66-160	JR66-160I	JR66-160IS	160	2,100	12,000	31.2
JR66-175	JR66-175I	JR66-175IS	175	2,950	16,000	32.9
JR66-180	JR66-180I	JR66-180IS	180	3,200	17,500	34.7
JR66-200	JR66-200I	JR66-200IS	200	4,400	24,000	36
JR66-225	JR66-225I	JR66-225IS	225	6,100	29,000	38
JR66-250	JR66-250I	JR66-250IS	250	7,800	40,000	42
JR66-275	JR66-275I	JR66-275IS	275	9,800	52,000	44.5
JR66-300	JR66-300I	JR66-300IS	300	12,500	60,000	46
JR66-315	JR66-315I	JR66-315IS	315	14,500	70,000	47
JR67-350	JR67-350I	JR67-350IS	350	32,000	150,000	50
JR67-400	JR67-400I	JR67-400IS	400	48,000	220,000	53
JR67-450	JR67-450I	JR67-450IS	450	72,000	320,000	57
JR67-500	JR67-500I	JR67-500IS	500	92,000	420,000	60

- 정격전압(Rated voltage) : 600V AC/DC
- 차단용량(Breaking capacity) : 100kA at AC/DC
- 동작과전압(Switching voltage) : 1,350V 이하(Less than 1,350V)

■ 인증서(Certificate)

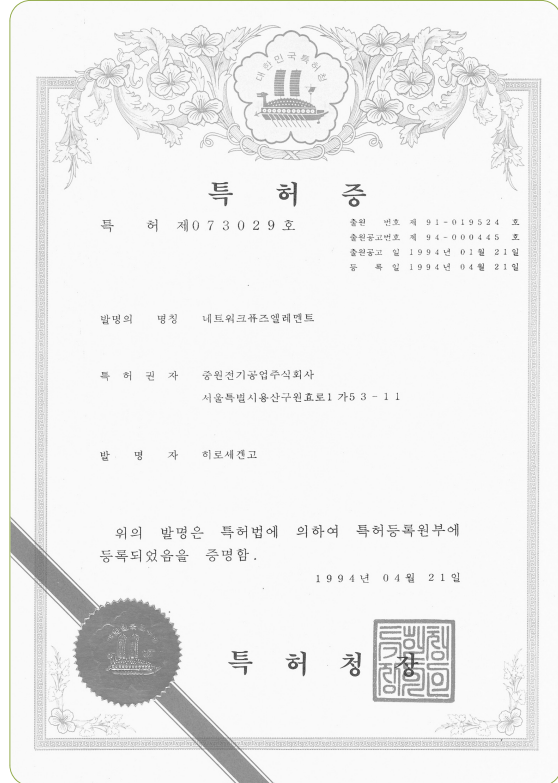
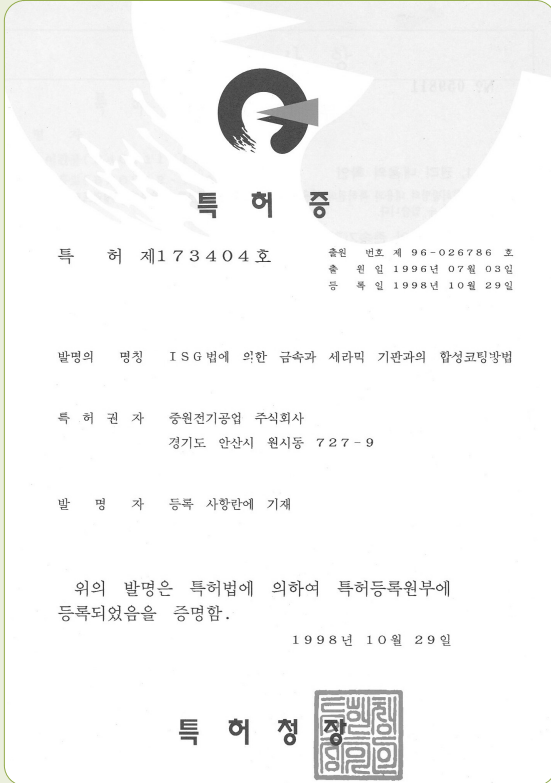

JR31-32

▶ 용단시간-전류특성(Pre-arcing Time-Current Characteristics)

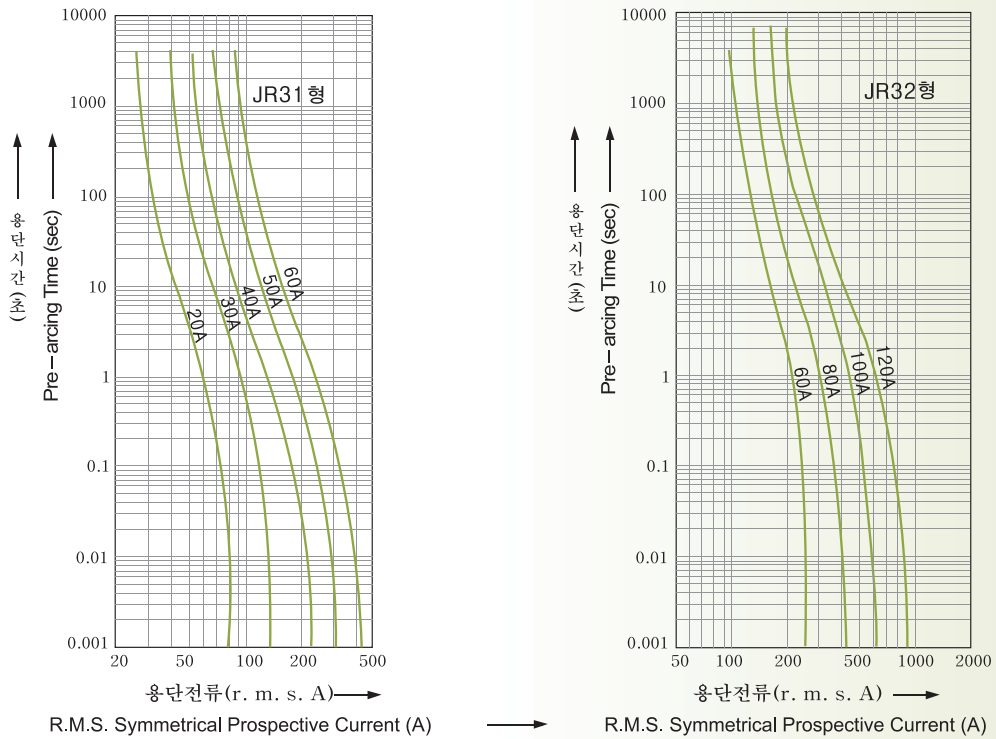

▶ 한류특성(Cut-off Current Characteristics)

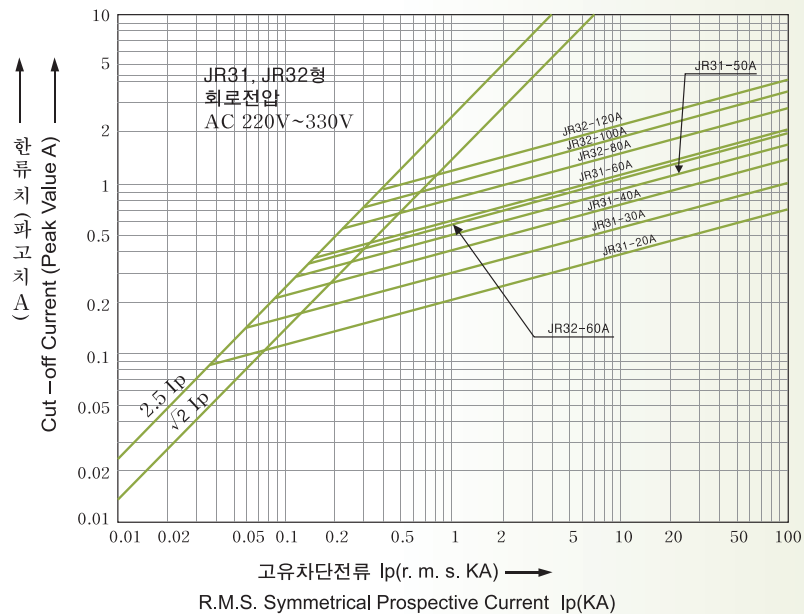

■ JR33-36

▶ 용단시간-전류특성(Pre-arcing Time-Current Characteristics)

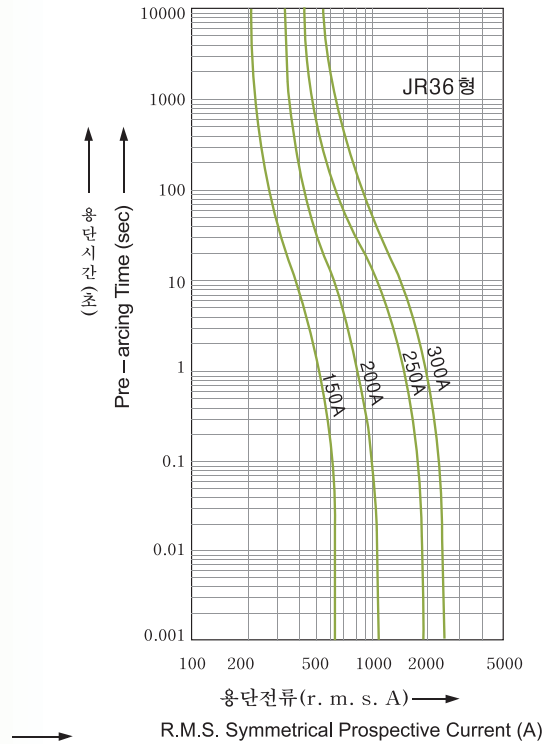
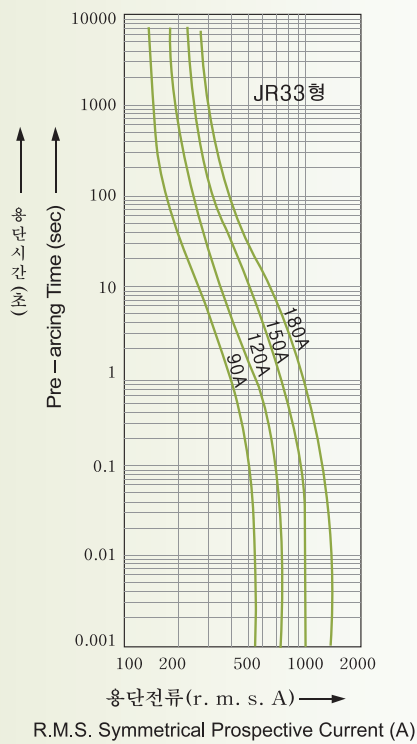

▶ 한류특성(Cut-off Current Characteristics)

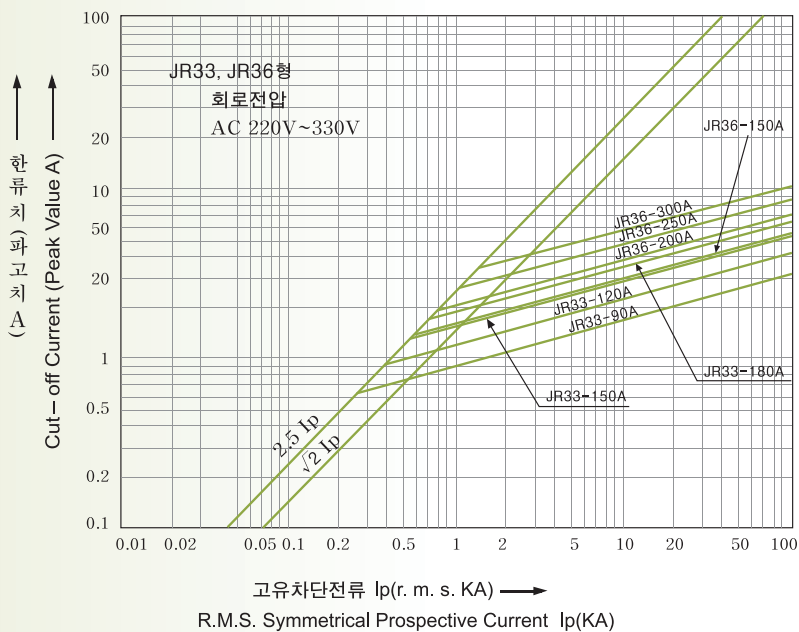

■ JR37

▶ 용단시간-전류특성(Pre-arcing Time-Current Characteristics)

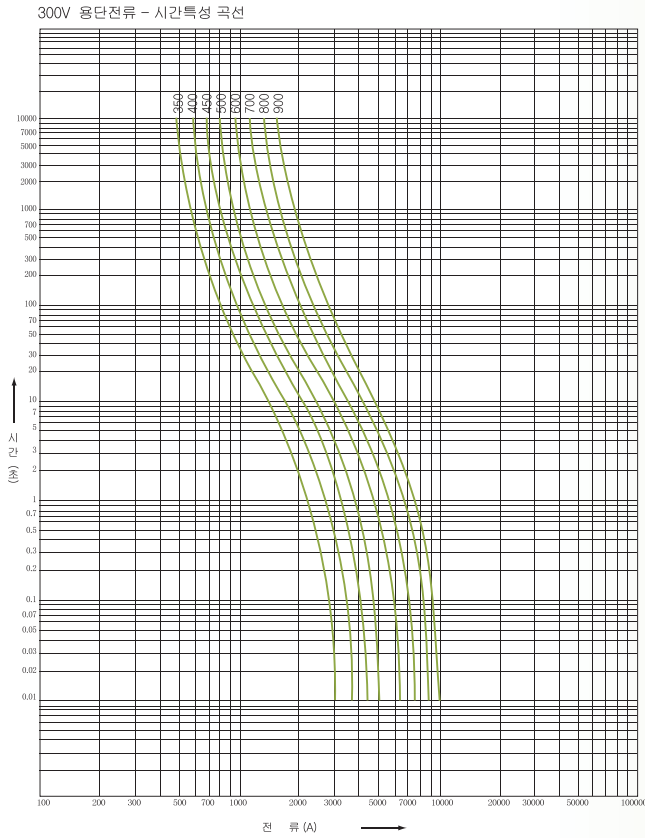

▶ 한류특성(Cut-off Current Characteristics)

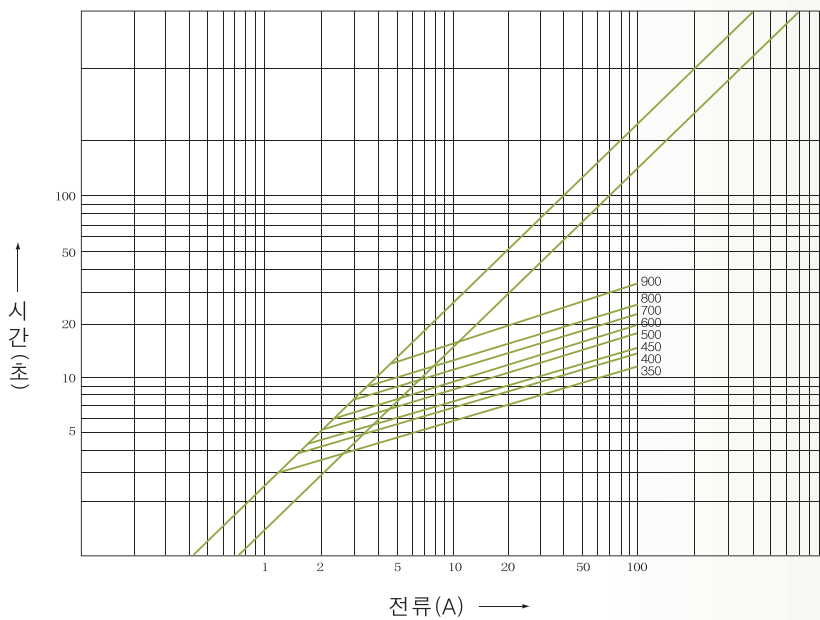

■ JR61-62

▶ 용단시간-전류특성(Pre-arcing Time-Current Characteristics)

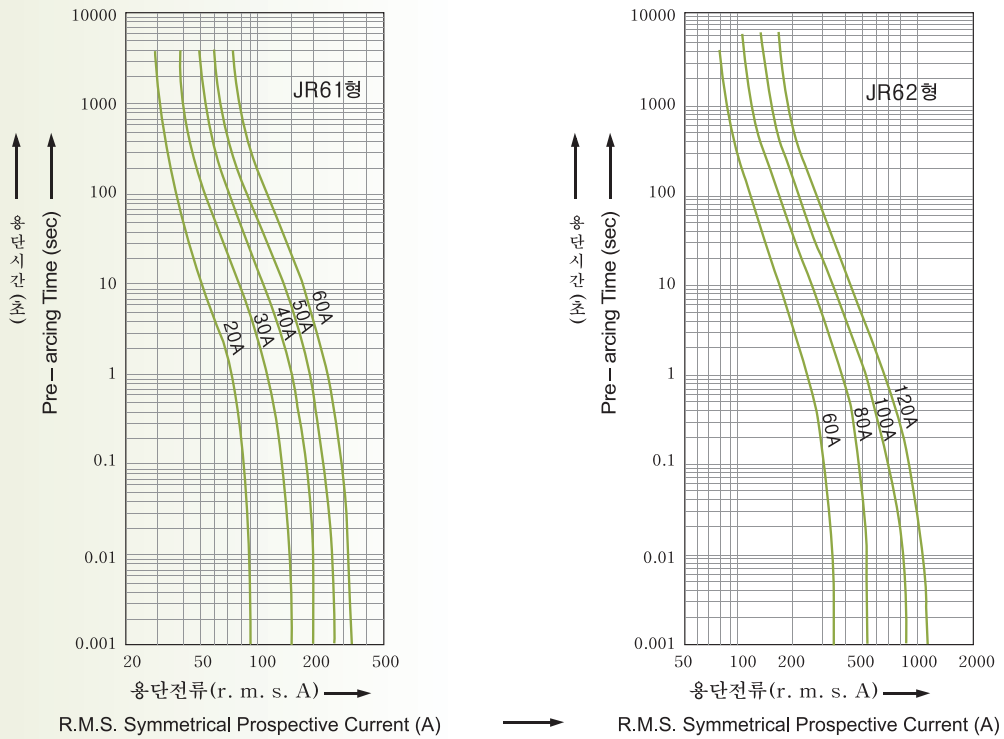

▶ 한류특성(Cut-off Current Characteristics)

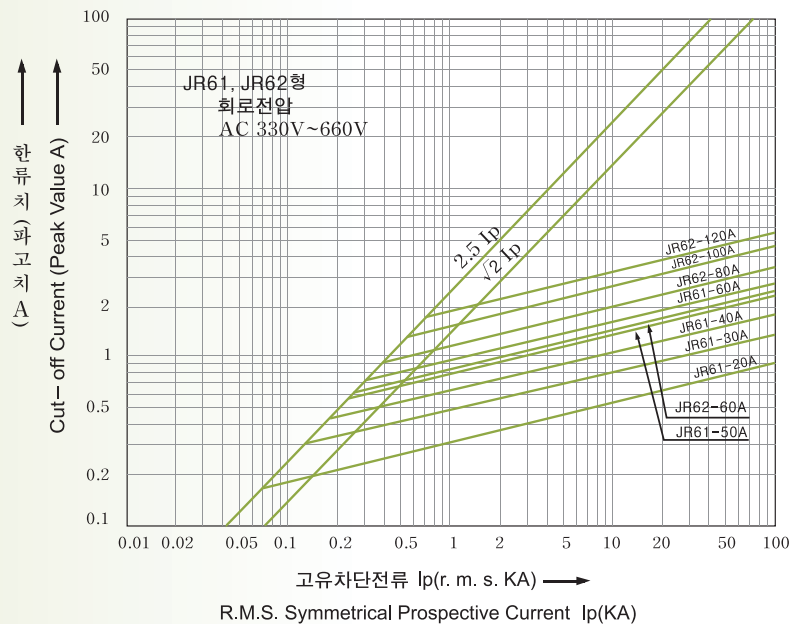

■ JR63-66

▶ 용단시간-전류특성(Pre-arcing Time-Current Characteristics)

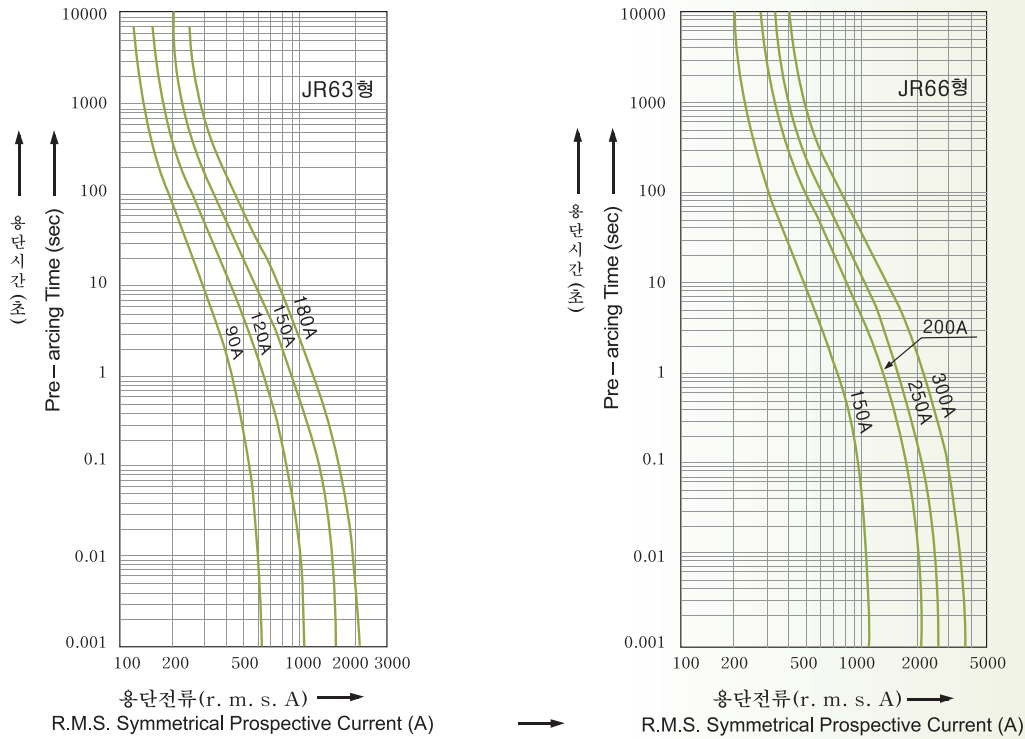

▶ 한류특성(Cut-off Current Characteristics)

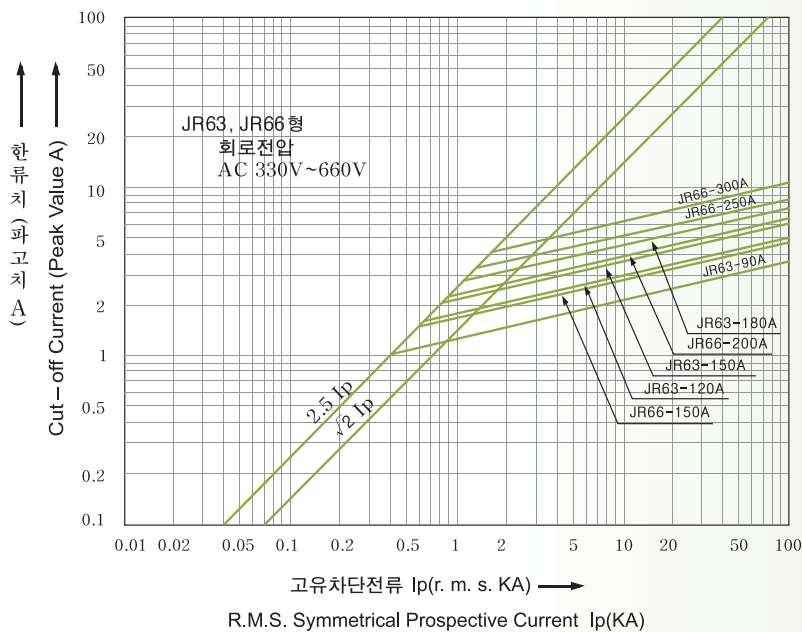

■ JR67

▶ 용단시간-전류특성(Pre-arcing Time-Current Characteristics)

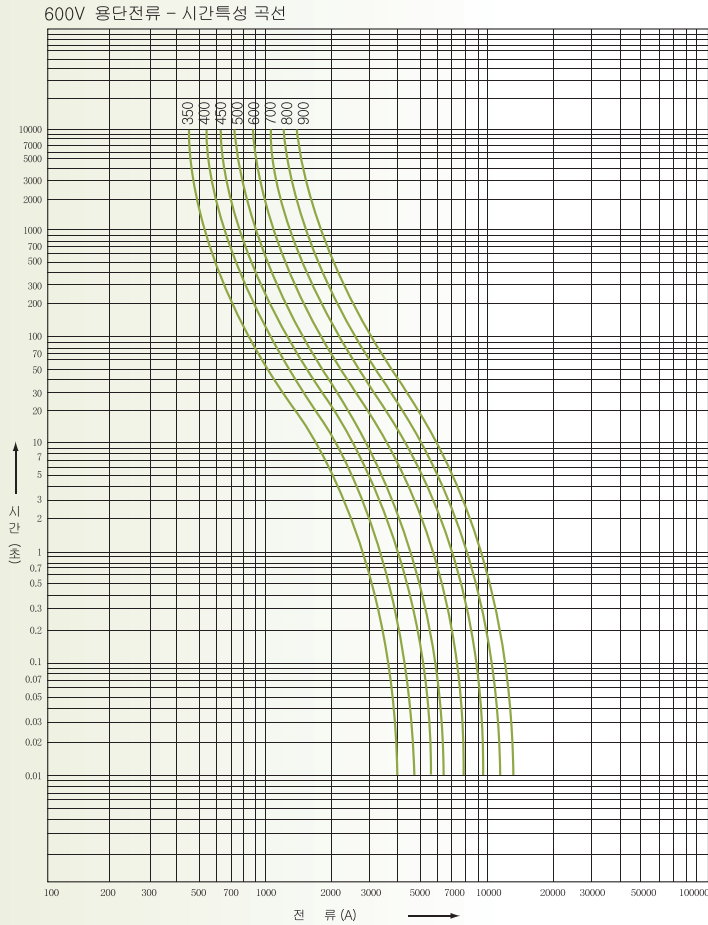

▶ 한류특성(Cut-off Current Characteristics)

