

NH000/I gG 2A/500V



Specifications

| | |
|---------------------------|---|
| ETI Code | 004191201 |
| Description | NH000/I gG 2A/500V |
| Weight | 120 |
| Level | Fuse links NH gG up to AC 690V |
| Product group | NV/NH low voltage NH knife blade fuses |
| Characteristics | gL/gG (cable protection/equipment protection) |
| Rated AC voltage (V) | 500 |
| Rated current (A) | 2 |
| Type | NH-I |
| Size | NH000 |
| Breaking capacity AC (kA) | 120 |
| Indicator | Combination fuse status indicator |

[Online product page](#)

Other documentation



[EU declaration](#)

[Technical data catalogue](#)

[3D Model](#)



ETIM international classification

| | |
|-------------------------------|---|
| Nominal rated current | 2A |
| Nominal rated voltage | 500V |
| Construction size | NH000 |
| Utilization category | gL/gG (cable protection/equipment protection) |
| Type of fuse status indicator | Combination fuse status indicator |
| Rated voltage AC | 500 |

Melting energy characteristics

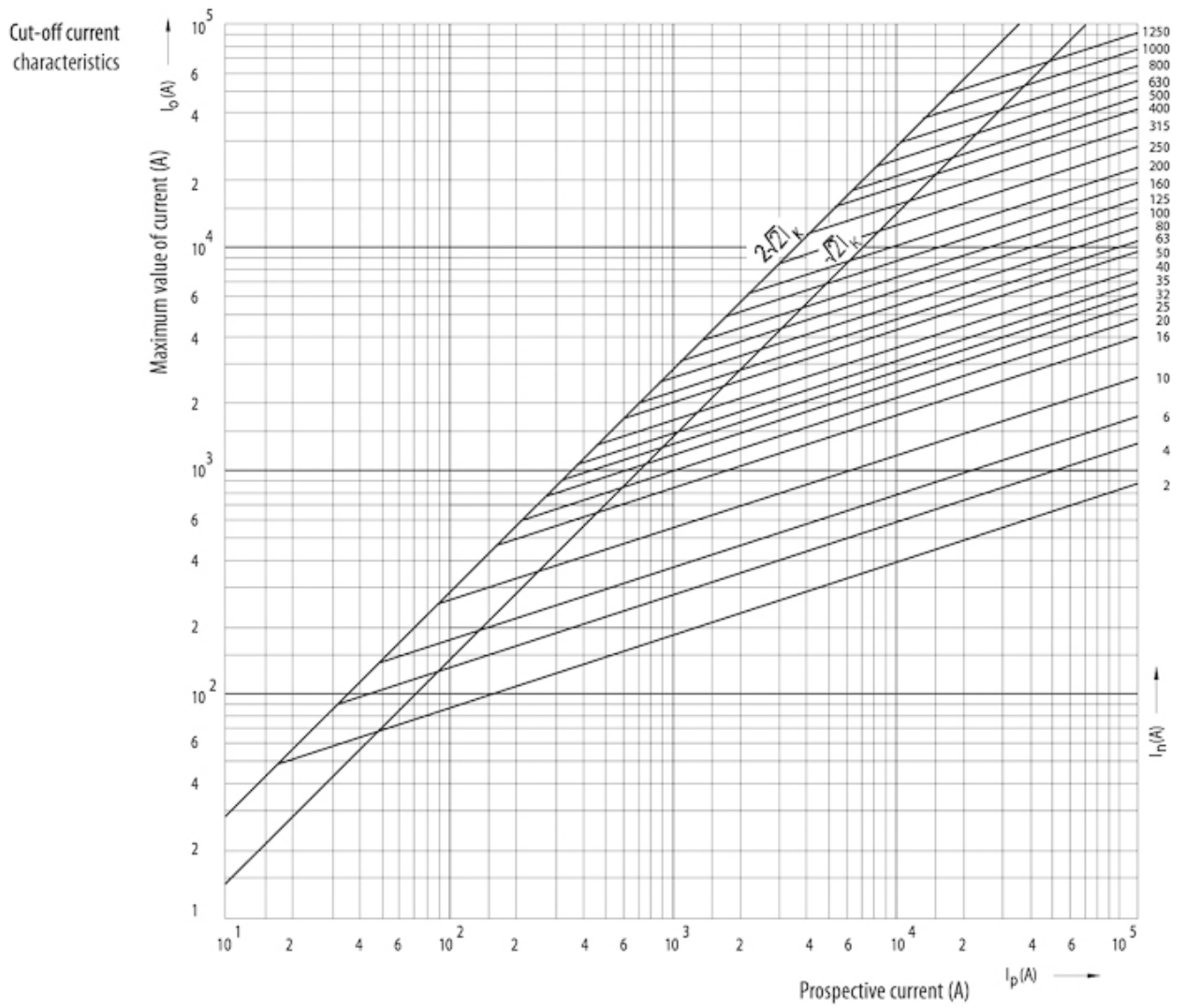

Time current characteristics

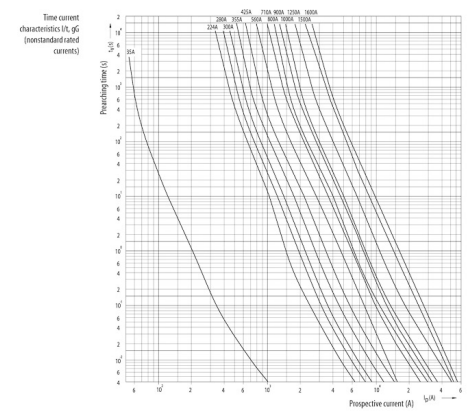
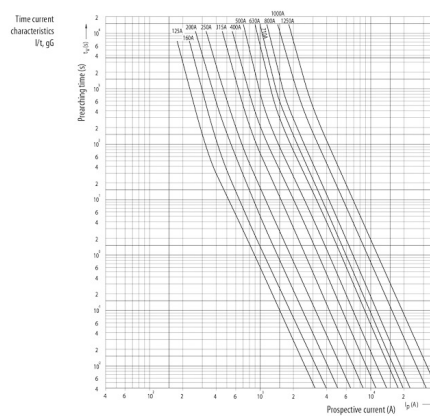
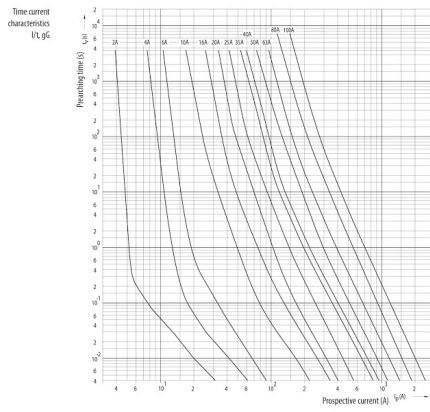

Dimension drawing

| | A | B | C | D | E | F | G | H | I | J | K | |
|-----------|-----|----|----|----|----|-----|-----|-----|-----|----|---|-------|
| NV00C | 79 | 53 | 47 | 35 | 15 | 21 | 52 | 7,5 | | | 6 | kombi |
| NV00C I | 79 | 53 | 47 | 35 | 15 | 21 | 52 | 7,5 | | | 6 | kombi |
| NV00 | 79 | 53 | 47 | 35 | 15 | 28 | 56 | 12 | | | 6 | kombi |
| NV00 I | 79 | 53 | 47 | 35 | 15 | 28 | 56 | 12 | | | 6 | kombi |
| NV0 | 125 | 68 | 65 | 35 | 15 | 28 | 56 | 12 | | | 6 | kombi |
| NV1C | 135 | 68 | 65 | 40 | 15 | 28 | 61 | 12 | | | 6 | kombi |
| NV1C I | 135 | 68 | 65 | 40 | 15 | 28 | 61 | 12 | | | 6 | kombi |
| NV1 | 135 | 72 | 65 | 40 | 20 | 46 | 65 | 14 | | | 6 | kombi |
| NV1 I | 135 | 72 | 65 | 40 | 20 | 46 | 65 | 14 | | | 6 | kombi |
| NV2C | 150 | 72 | 65 | 48 | 20 | 46 | 73 | 14 | | | 6 | kombi |
| NV2C I | 150 | 72 | 65 | 48 | 20 | 46 | 73 | 14 | | | 6 | kombi |
| NV2 | 150 | 72 | 65 | 48 | 26 | 54 | 73 | 14 | | | 6 | kombi |
| NV2 I | 150 | 72 | 65 | 48 | 26 | 54 | 73 | 14 | | | 6 | kombi |
| NV3C | 150 | 72 | 65 | 60 | 26 | 54 | 84 | 14 | | | 6 | kombi |
| NV3 | 150 | 72 | 65 | 60 | 33 | 65 | 84 | 14 | | | 6 | kombi |
| NV4 | 200 | 75 | 66 | 87 | 50 | 100 | 121 | 24 | 150 | 16 | 8 | |
| NV4a | 200 | 99 | 87 | 85 | 50 | 95 | 121 | 27 | | | 6 | |
| NV4a SI* | 200 | 99 | 87 | 85 | 50 | 95 | 121 | 27 | | | 6 | |
| NV1/1000V | 155 | 90 | 87 | 40 | 20 | 45 | 59 | 9 | | | 6 | |

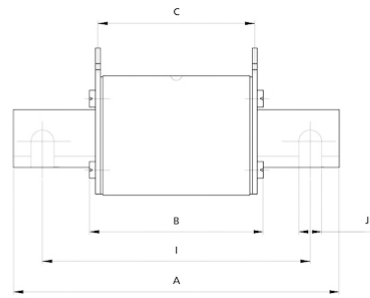

| | Striker pin | | | |
|-----|-------------|------|------|-----|
| | K | L | M | S1 |
| 00C | 0 | 20.7 | 16.7 | 7.5 |
| 00 | 0 | 20.7 | 16.7 | 7.5 |
| 1 | 13.7 | 19.7 | 25 | 12 |
| 2 | 16.2 | 27.4 | 25 | 12 |
| 3 | 17 | 35.6 | 25 | 12 |
| 4a | 24 | 49 | 25 | 12 |

