

# NH2 gG 32A/1200V



## Specifications

ETI Code	004113736
Description	NH2 gG 32A/1200V
Level	SPECIAL PURPOSE FUSES SPF
Rated current (A)	32
Type	NH
Size	2XL
Product group	Special purpose fuses
Product subgroup	Non standard gG
Characteristics	gL/gG (cable protection/equipment protection)
Rated AC voltage (V)	1200
Indicator	Top fuse status indicator
Power dissipation (W)	5,8
Standards	IEC 60269

Online product page

## Other documentation



Technical data catalogue



## ETIM international classification

Nominal rated current	32A
Nominal rated voltage	V
Construction size	Other
Utilization category	gL/gG (cable protection/equipment protection)
Type of fuse status indicator	Top fuse status indicator
Breaking capacity	50
Rated voltage AC	1200

# Time current characteristics

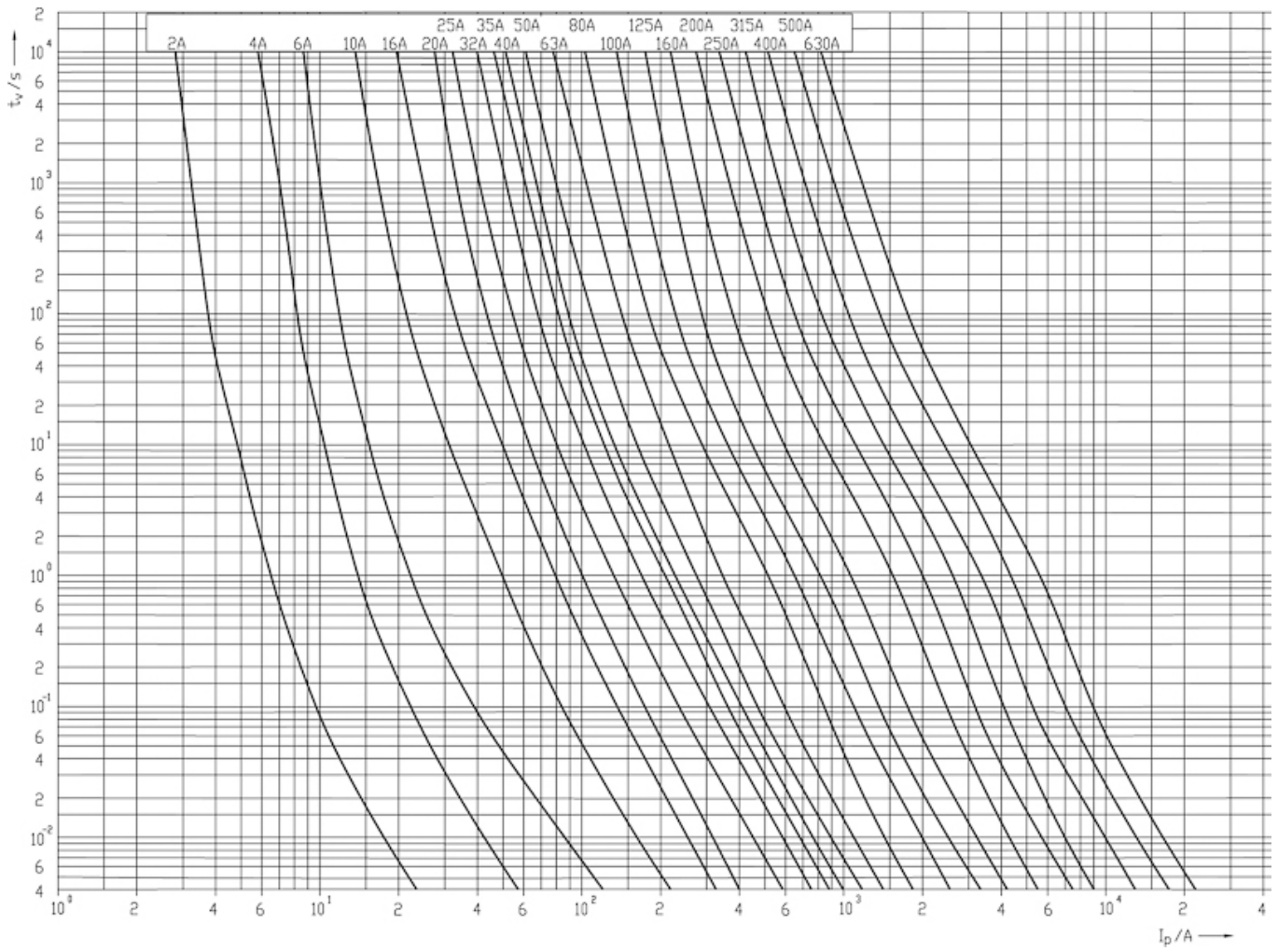

## Dimension drawing

Standard indicator

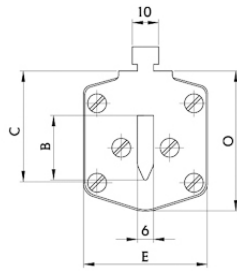
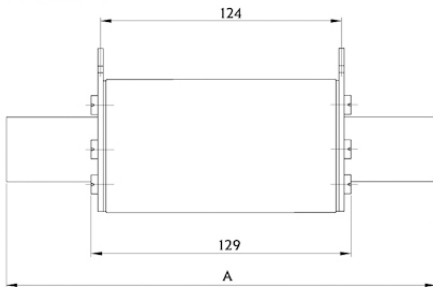

Size	Dimensions [mm]								
	A	B	C	E	G	P	R	M	O
1XL	194	24	40	46	61,5	20,5	13,7	50	52
2XL	209	30	48	54	71	27,3	16,2	59	61
3L	209	37	60	64	82	35,6	17,0	70	74

Striker indicator

