

NH2/K gG 160A/690V



Specifications

ETI Code	004114345
Description	NH2/K gG 160A/690V
Weight	570
Level	Fuse links NH gG up to AC 690V
Product group	NV/NH low voltage NH knife blade fuses
Characteristics	gL/gG (cable protection/equipment protection)
Rated AC voltage (V)	690
Rated current (A)	160
Type	NH
Size	NH2
Breaking capacity AC (kA)	120
Indicator	striker

Online product page

Other documentation



Technical data catalogue



ETIM international classification

Nominal rated current	160A
Nominal rated voltage	690V
Construction size	NH2
Utilization category	gL/gG (cable protection/equipment protection)
Type of fuse status indicator	Other
Rated voltage AC	690

Melting energy characteristics

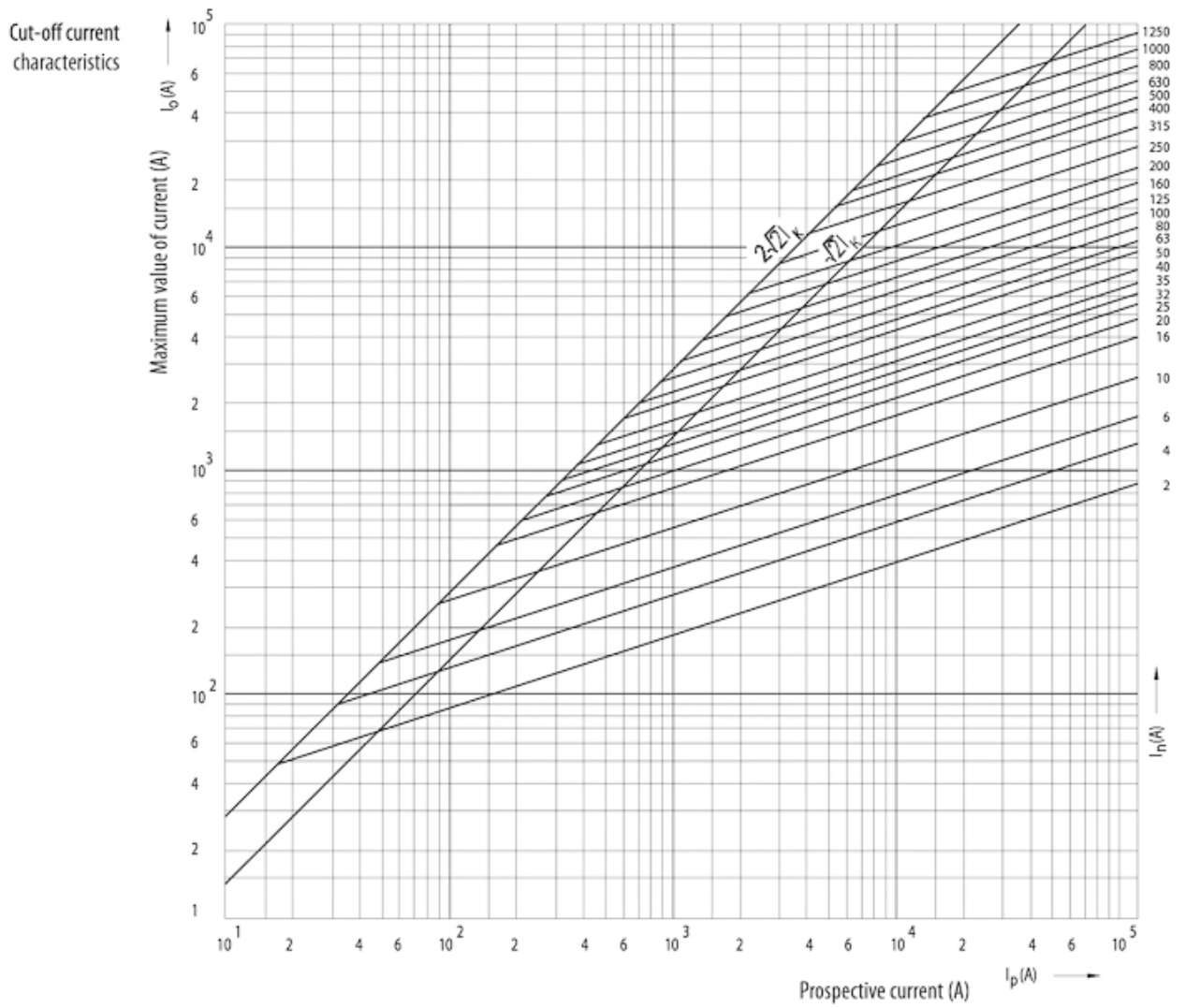

Time current characteristics

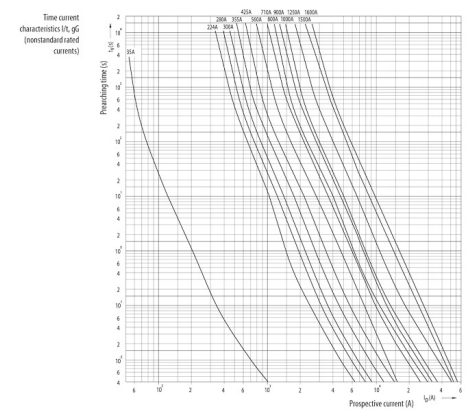
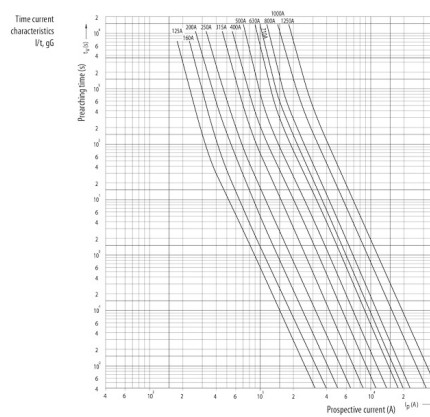
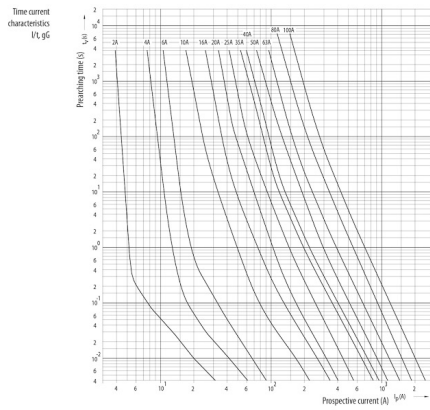

Dimension drawing

	A	B	C	D	E	F	G	H	I	J	K	
NV00C	79	53	47	35	15	21	52	7,5			6	kombi
NV00C I	79	53	47	35	15	21	52	7,5			6	kombi
NV00	79	53	47	35	15	28	56	12			6	kombi
NV00 I	79	53	47	35	15	28	56	12			6	kombi
NV0	125	68	65	35	15	28	56	12			6	kombi
NV1C	135	68	65	40	15	28	61	12			6	kombi
NV1C I	135	68	65	40	15	28	61	12			6	kombi
NV1	135	72	65	40	20	46	65	14			6	kombi
NV1 I	135	72	65	40	20	46	65	14			6	kombi
NV2C	150	72	65	48	20	46	73	14			6	kombi
NV2C I	150	72	65	48	20	46	73	14			6	kombi
NV2	150	72	65	48	26	54	73	14			6	kombi
NV2 I	150	72	65	48	26	54	73	14			6	kombi
NV3C	150	72	65	60	26	54	84	14			6	kombi
NV3	150	72	65	60	33	65	84	14			6	kombi
NV4	200	75	66	87	50	100	121	24	150	16	8	
NV4a	200	99	87	85	50	95	121	27			6	
NV4a SI*	200	99	87	85	50	95	121	27			6	
NV1/1000V	155	90	87	40	20	45	59	9			6	

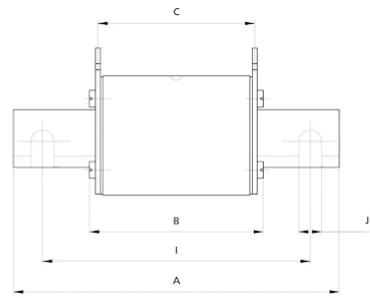

	Striker pin			
	K	L	M	S1
00C	0	20.7	16.7	7.5
00	0	20.7	16.7	7.5
1	13.7	19.7	25	12
2	16.2	27.4	25	12
3	17	35.6	25	12
4a	24	49	25	12

